

MARY DUKE BIDDLE TRENT SEMANS CONFERENCE CENTER

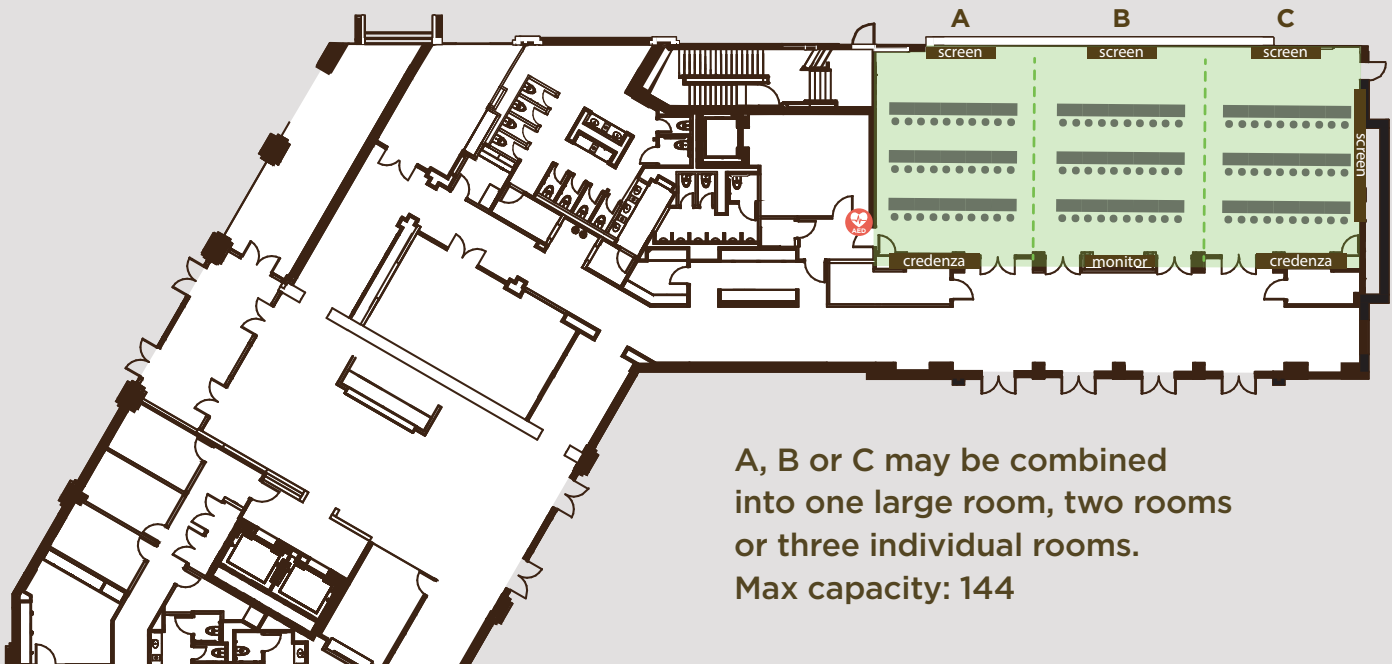

A, B or C may be combined into one large room, two rooms or three individual rooms.
Max capacity: 144

Audio

- Centralized audio control panel
- Microphones: wireless hand-held (3), lavalier (3)
- Specialized wireless table microphones (30)*
- Ceiling-mounted speakers
- Convenience phone

Video/Display

- Blu-ray/DVD
- Ceiling-mounted 8000lm laser projectors and 123" screens (3)
- Additional 173" screen (C only)
- 70" wall-mounted flat screen (B only)
- Display capabilities include webinar and web conferencing
- Video conferencing**

Staging and Technology

- Lecterns (3): microphone, 22" monitor, keyboard/mouse
- Flash drive ready presenter/host desktop
- "Plug and present" HDMI and VGA connections for guest laptops
- In-table power outlets
- Guest Wi-Fi internet access
- Risers: 6' by 8' staging (4)
- Adjustable lighting, blackout and sun shades
- Presentation remote, laser pointer, flip charts, easels, markers

Audio Visual Equipment

Please discuss all audio visual needs at least two weeks prior to the meeting date. There are no fees associated with using the in-house equipment listed above.

Paula W. Greene, CMP, Events Manager
Contact: pgreene@tde.org, (704) 969-2147

* Supports four simultaneous participants

** Requires testing with A/V staff two weeks prior to event

THE DUKE ENDOWMENT

Standard Classroom (90 maximum capacity)

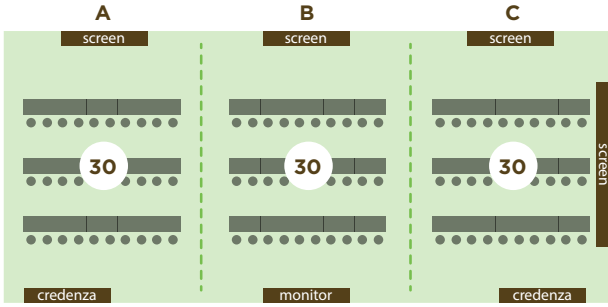

U-Shape (72 maximum capacity)

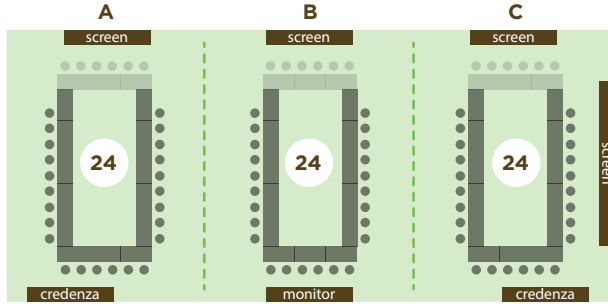

Closed u-shape accommodates 6 additional guests in each section

Conference Room (58 maximum capacity)

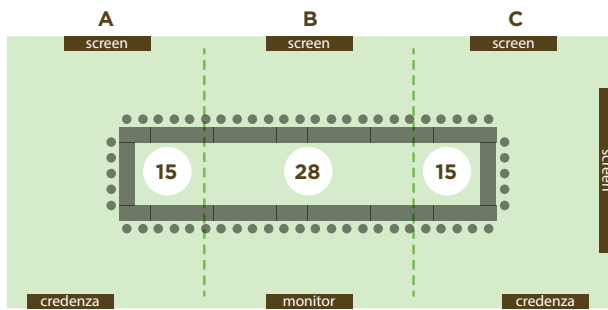

Theater (144 maximum capacity)

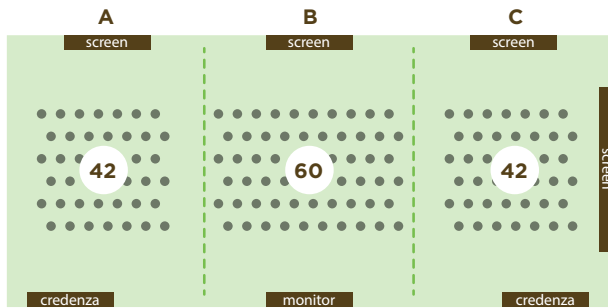

Four-Sided Square Pods (120 maximum capacity)

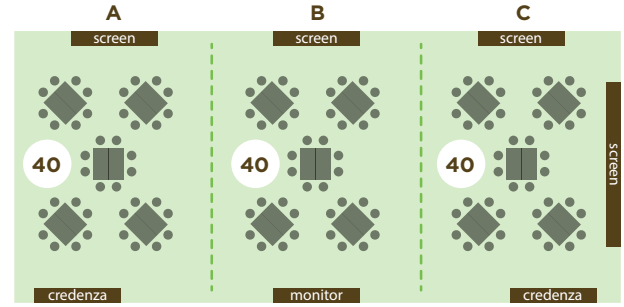

Three-Sided Square Pods (72 maximum capacity)

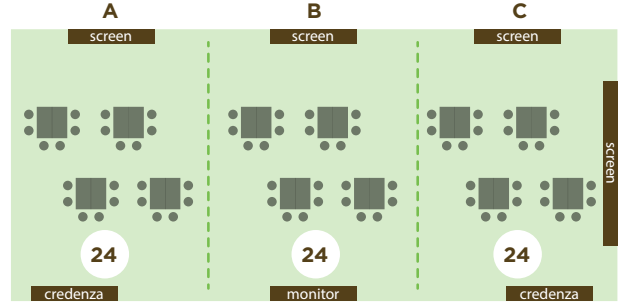

T-Shape (84 maximum capacity)

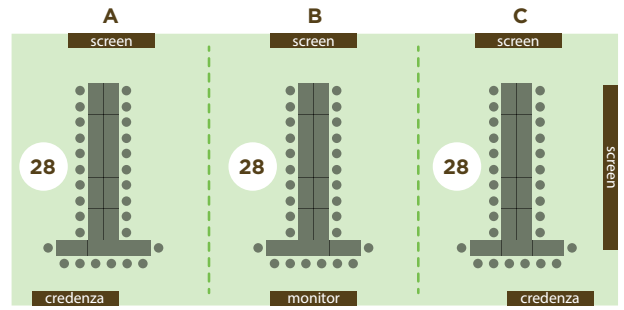

Two-Tiered (96 maximum capacity)

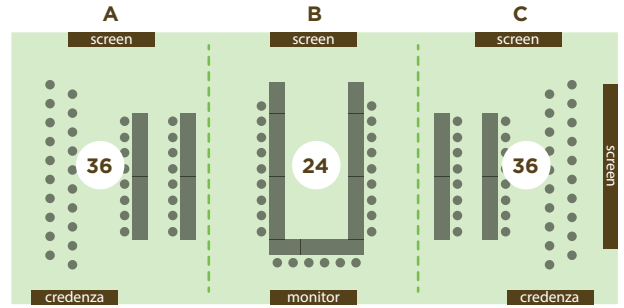

Custom Configurations Available (142 maximum capacity)

