

# HERITAGE ROOM

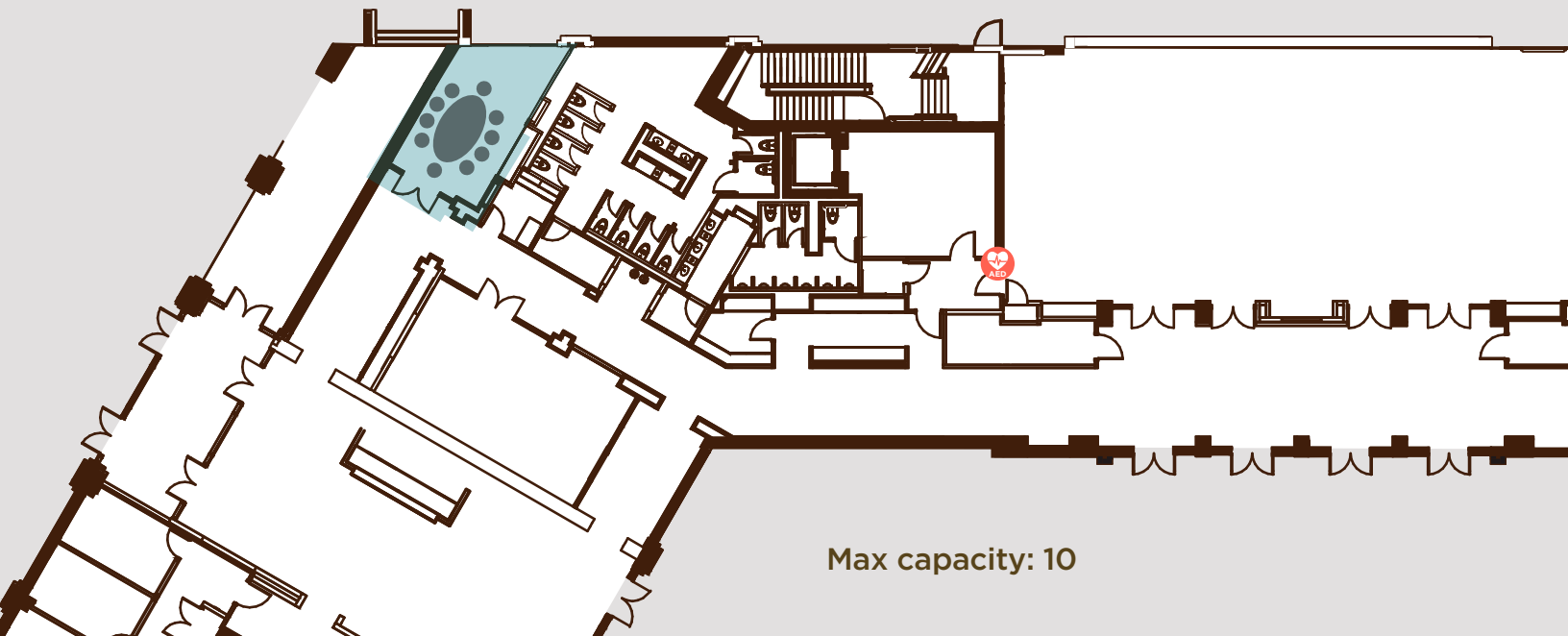

Max capacity: 10



#### Audio

- Wireless table microphones
- Ceiling-mounted speakers
- Convenience phone

#### Video/Display

- Blu-ray/DVD
- Ceiling-mounted LCD projector and 92" screen
- Display capabilities include webinar and web conferencing

#### Technology

- Flash drive ready presenter/host desktop
- "Plug and present" HDMI and VGA connections for guest laptops
- In-table power outlets
- Guest Wi-Fi internet access
- Adjustable lighting, blackout and sun shades
- Presentation remote, laser pointer, flip charts, easels, markers

#### Audio Visual Equipment

Please discuss all audio visual needs at least two weeks prior to the meeting date. There are no fees associated with using the in-house audio visual equipment listed.

**Paula W. Greene, Events Manager**  
pgreene@tde.org, 704.969.2147

*James B. Duke*

THE DUKE ENDOWMENT